

S60

Commercial Suspension Elliptical Trainer



ASSEMBLY GUIDE



S60

COMMERCIAL SUSPENSION ELLIPTICAL TRAINER

To avoid possible damage to this Suspension Elliptical™ Trainer, please follow assembly steps in the correct order. Before proceeding, find your new Suspension Elliptical™ Trainer's serial number located on the front axle tube, and enter here:

Refer to this number when calling for service, and enter this serial number on your Warranty Card and in your own records. Be sure to read your Owner's Guide before using your new Suspension Elliptical™ Trainer.
If any parts, hardware or tools are missing, please call your local dealer.

NOTE: It is recommended that you apply grease to the threads of each bolt and screw as you assemble your Suspension Elliptical™ Trainer to prevent loosening and noise. Also, during each assembly step, ensure that ALL bolts and screws are in place and partially threaded in before completely tightening any ONE bolt or screw.

HARDWARE INCLUDED

PINK BAG

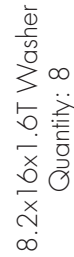
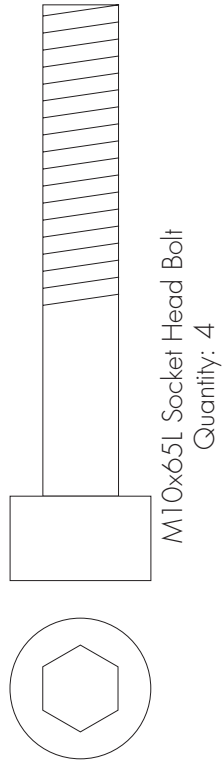

BLUE BAGS

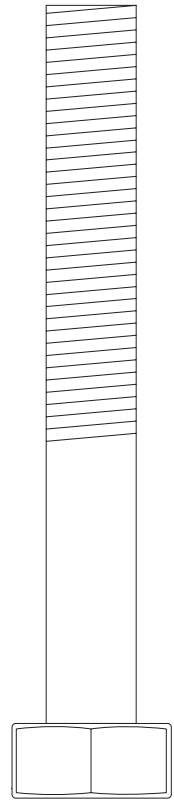
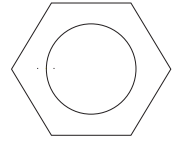
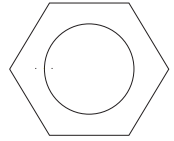
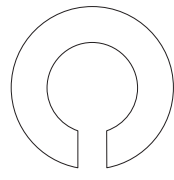

RED BAG

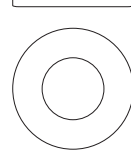
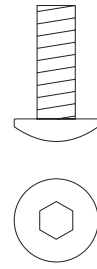

HARDWARE INCLUDED

GREEN BAGS x2

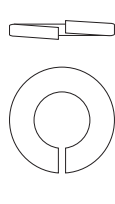
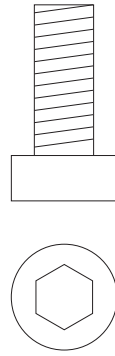
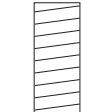
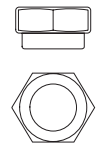
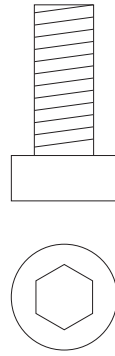
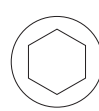

BLACK BAGS x2

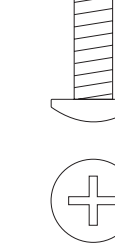

YELLOW BAG

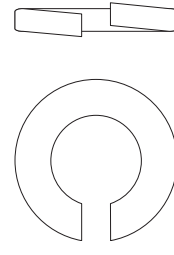
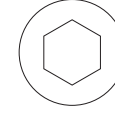

S60 ASSEMBLY GUIDE

TOOLS & PARTS INCLUDED

Screwdriver

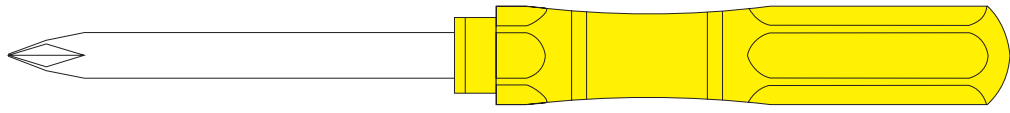

6mm LShaped Wrench



8mm LShaped Wrench



PARTS BOX

Console Mast
Console Mast Boot
Accessory Tray
Colorcoded Hardware Bags
Owner's Guide
Assembly Guide
Warranty Card

6mm TShaped Wrench

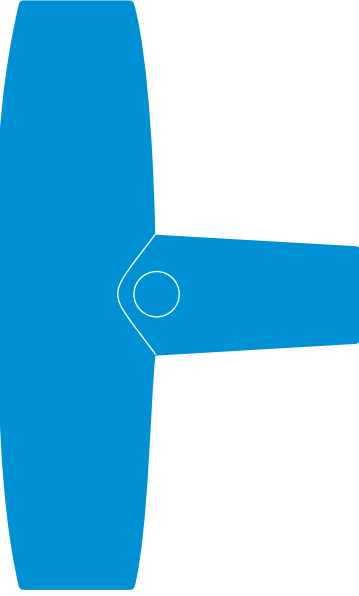

Multi-Wrench,
Qty. 2

STEP 1**YELLOW BAG**

- Slide the console mast boot onto the console mast.
- Put the console wire through console mast.
- Set console mast into the console mast bracket by four bolts (M10x20L) and lock washers by 8mm L-shaped wrench.

STEP 2**RED BAGS**

- Attach Adjustable Arm (right) onto the right side of base frame and fasten by two bolts (M12x20L) and flat washers by 8mm L-shaped wrench.
- Attach Adjustable Arm (left) onto the left side of base frame by two bolts (M12x20L) and flat washers by 8mm L-shaped wrench.

Attention: DO NOT screw the bolts and washer tight, after Step 3 complete then fasten all the bolts.

STEP 3**PINK BAG**

NOTE: A second person will be helpful to complete this step.

- Place the left connection arm over the left arm and connect with two socket head cap bolts (M10x65L). Tighten only a few turns with the 8mm L-shaped wrench.
- Insert the pin on the front flange of the connection arm to the hole in the console mast elevation bracket.
- Repeat these steps on the right side.
- When the pins of both connection arms are seated in the holes of the console mast elevation bracket lift the entire assembly slightly to line up the screw holes. Insert four socket head cap bolts (M8x30L) with washers (8.2x16x1.6T) through these holes. Secure with a washer (8.2x16x1.6T) and nylon nut (M8) to each bolt. Tighten with the 6mm L-shaped wrench and 13mm wrench.
- Go back and completely tighten the screws that connect the connection arms to the adjustable arm with the 8mm L-shaped wrench.

STEP 4**BLUE BAG**

- Lift the left adjustable arm and insert the bearing end of the suspension arm into the bracket of the adjustable arm. From the outside, insert a hex head bolt (M12x95L) through the bracket and suspension arm.
- Secure with a lock washer (M12) and nut (M12). Tighten with two 19mm wrenches. Make sure hardware is tight.
- Repeat this step on the right side.

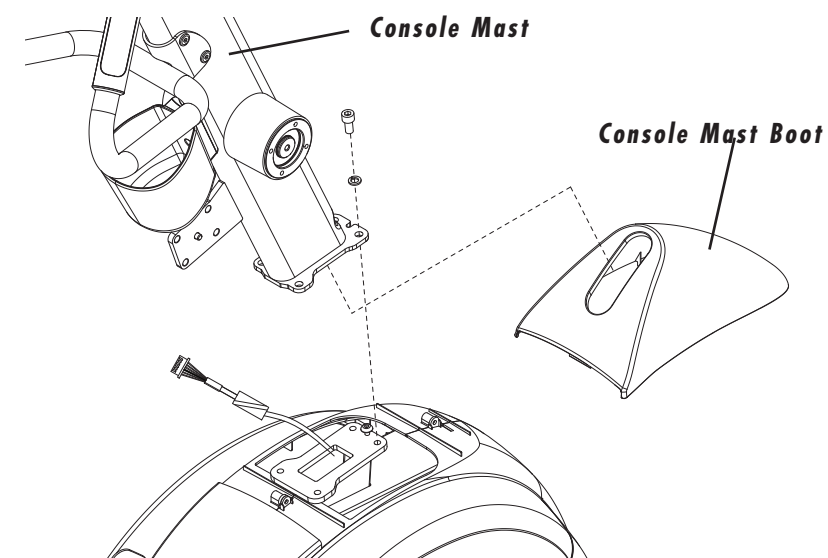
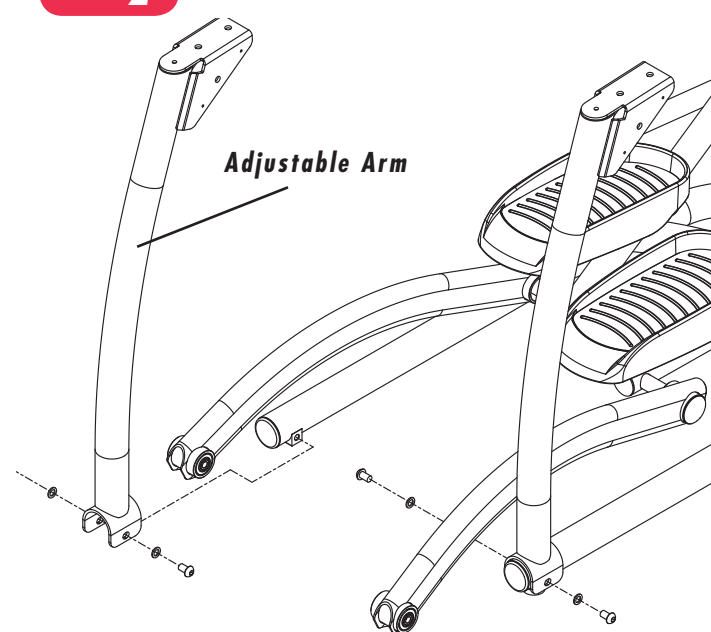
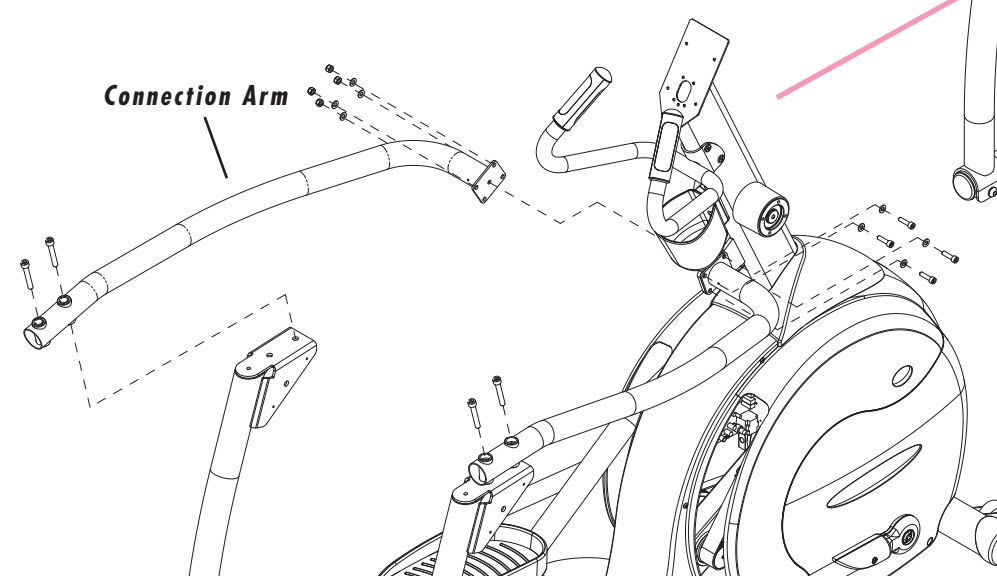
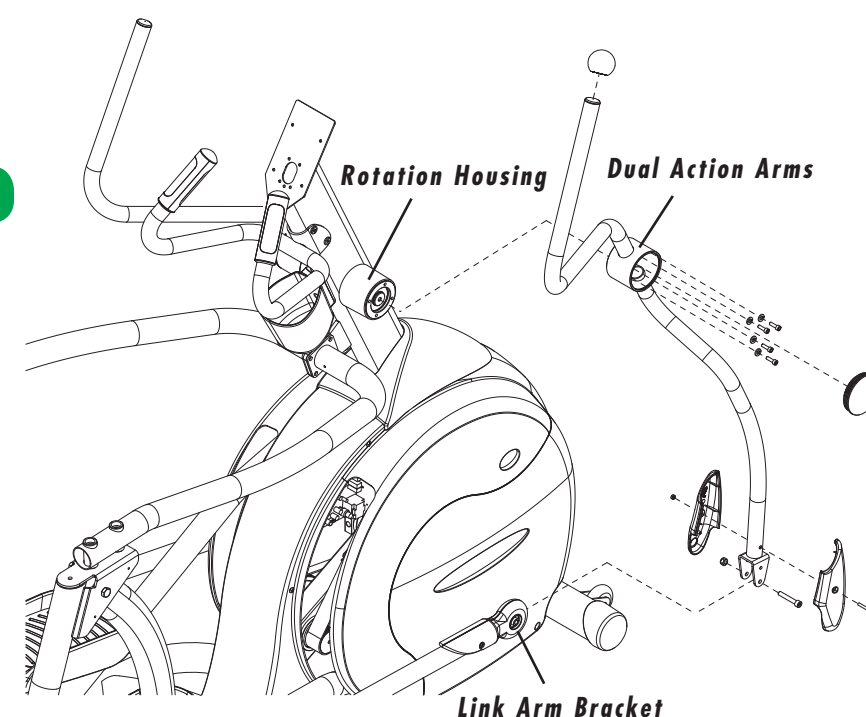
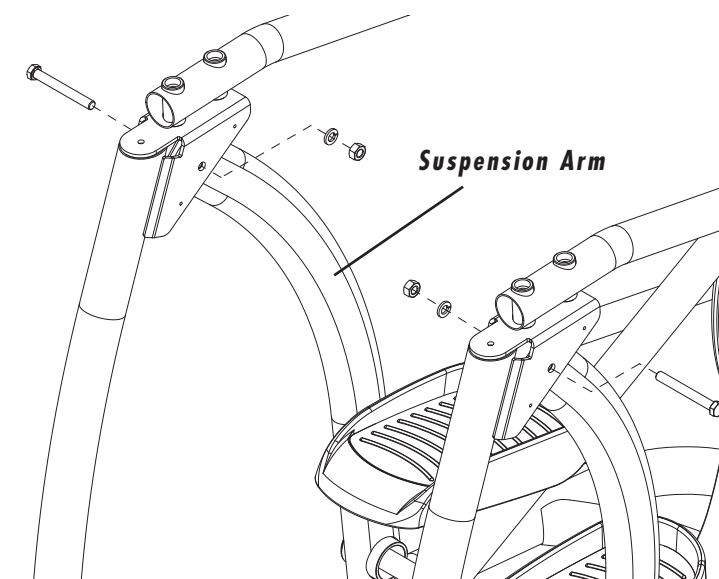
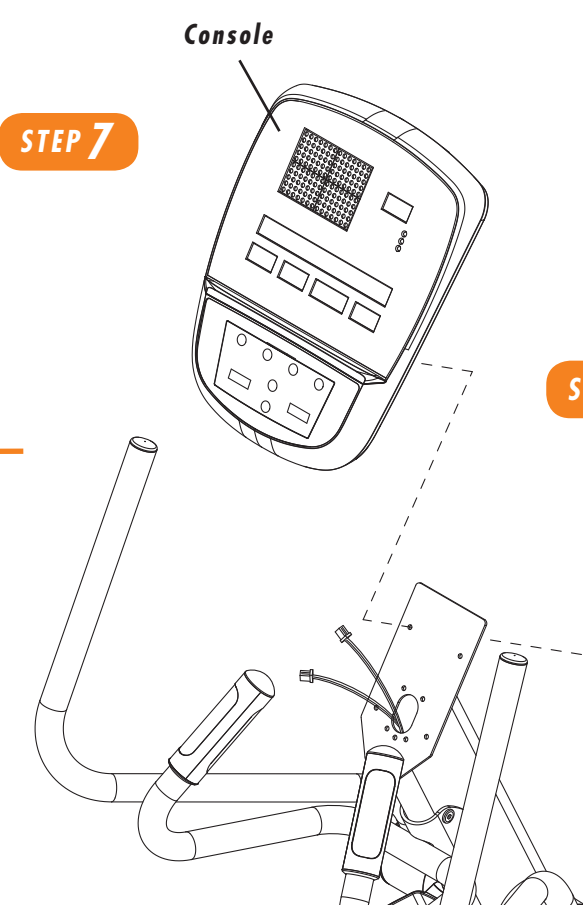
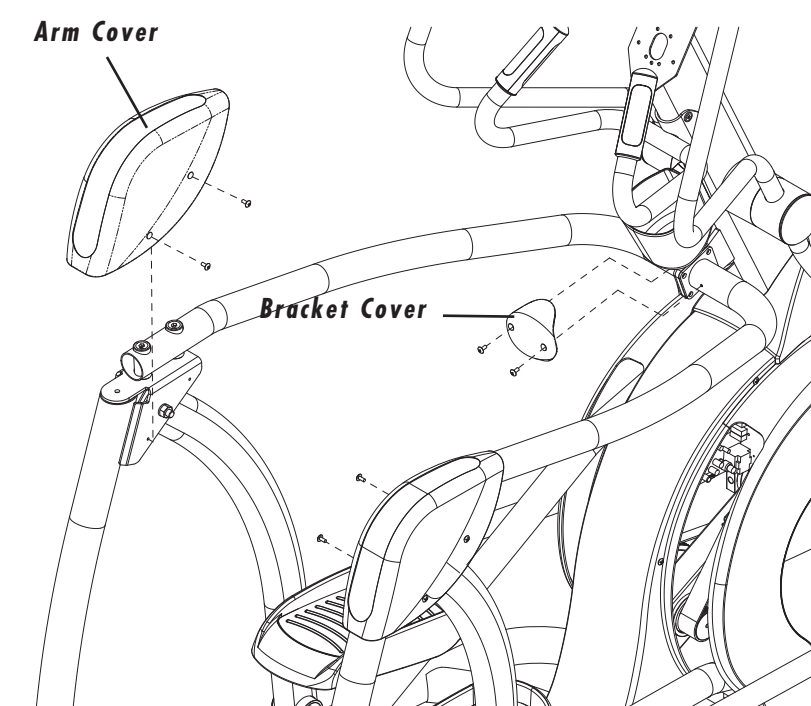
STEP 1**STEP 2****STEP 3****STEP 5****STEP 4****STEP 7****STEP 6****STEP 5****GREEN BAGS**

- Assemble Dual Action Arm on the Rotation Housing by four bolts (M6x20L) and four Lock Washer (M6), then fasten by 5mm T-shaped wrench.
- Line up the rotation housing cover over the rotation housing and push to snap in place.
- Slide the link arm between the flanges of the dual-action arm bracket. Insert a socket head cap bolt (M8x50L) through the hole to connect the brackets. Secure with a M8 washer and nylon nut (M8). Tighten with the 10mm wrench and 5mm L-shaped wrench.
- Set the dual-action cover in place over the connection bracket. Place the nut (M5) into the recess on the inside cover. Insert a bolt (M5x50L) through the outside hole and tighten to the nut with a screwdriver.
- Repeat these steps on the right side.

STEP 6**BLACK BAG**

- Fasten Bracket Cover to console mast by two bolts (M5x15L).
- Set the right side Arm Cover into connection arm and fasten by four bolts (M5x25L). Then repeat the steps on the left side.

STEP 7**CONSOLE**

- Plug in the 9-volt battery. Re-attach the console back cover with the four screws removed previously.
- Connect the wires that come from the console mast into the plugs located in the back of the console. Attach the console to the mast with the four screws.